

STATE OF NORTH CAROLINA
DEPARTMENT OF TRANSPORTATION
HIGHWAY DIVISION 6

**PLANS & DETAILS –
REVISED – 9-10-2019**

**DATE AND TIME OF BID
OPENING:** **SEPTEMBER 18, 2019 AT 2:00 PM**

CONTRACT ID: **D6D1.POC.009**

TIP NO.: **-----**

FEDERAL AID NO.: **15406.1078057, 15406.1078267, 15406.1078279 &
15406.1078280**

WBS ELEMENT NO.: **15406.1078057, 15406.1078267, 15406.1078279 &
15406.1078280**

ROUTE NO.: **I-95, NC 71 & NC 710**

LOCATION: **HURRICANE FLORENCE SITES**

COUNTY: **ROBESON**

LENGTH OF PROJECT: **VARIES**

TYPE OF WORK: **WASHOUTS & SCOUR REPAIRS**

WBS Number 15406.1078057

I-95 4.4 MP 34.5369 -79.2442

Culvert# 770089

Scour Along Culvert Toewall, inlet & outlet 40'W X 5'L X 2'H = 25 tons
15'W X 15'L X 2'H = 25 tons

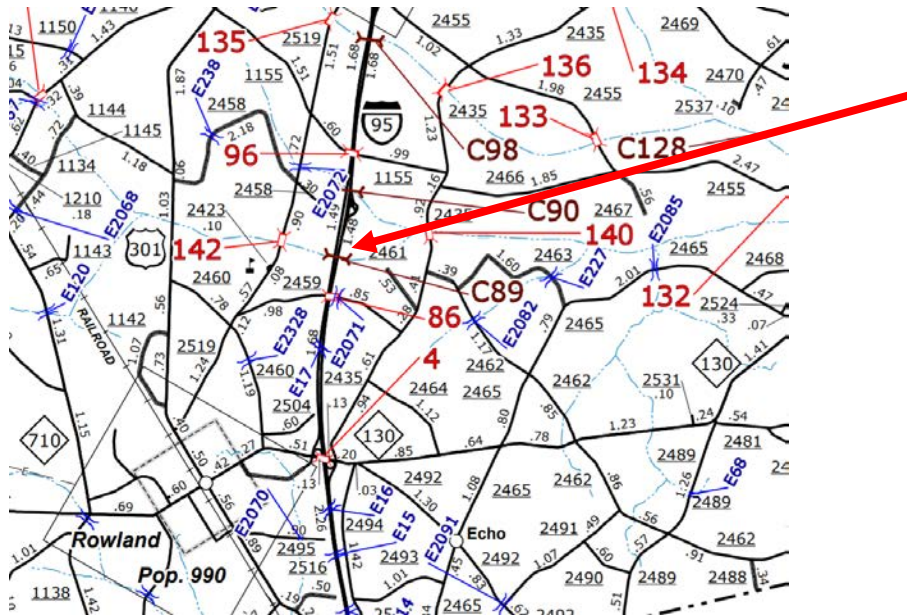

- Barrel 1 Section 1: West side 6.5' curtain wall exposed, east side 3.8' curtain wall exposed.
- Barrel 2 Section 1: West side 8.5' curtain wall exposed, east side 4.5' curtain wall exposed.
- Barrel 3 Section 1: West side 8.5' curtain wall exposed, east side 2.7' curtain wall exposed.
- Barrel 4 Section 1: West side 8.3' curtain wall exposed, east side 1' curtain wall exposed.
- Add Class B to washes along NW Wing, approx. 20'x5' deep
- Add Class B to washes along SE Wing, approx. 2.8'x4' deep
- Turbidity curtain to be used downstream of site

Contractor shall place Class B Stone in the scour hole located on the inlet and outlet side of the culvert. Contractor shall check the depth of stone prior, during, and after placement to ensure scour hole is filled. Turbidity curtain shall be used. Non-nylon matting shall be used at all sites on this project. All work on 95 shall be completed at night, if lane closure required. Lane closures on I-95 restricted to hours of work 9pm-6am Sun night and 7pm-6am Mon-Thurs night. No work on Saturdays or Holidays. Non-nylon matting shall be used at this slope and all others. Portable lighting is incidental to traffic control. Shoulder closures are permitted in the daytime.

WBS Number 15406.1078267

Culvert #770092 on NC 71 Scour along culvert toewall inlet and outlet 27'W X 5'H X 2'L = 25 tons X 2 = 50 tons, N34.893116 W79.063117 LITTLE MARSH SWAMP ON NC71 CULVERT, approximately 0.17 mile NE of SR 1709, Chason Road

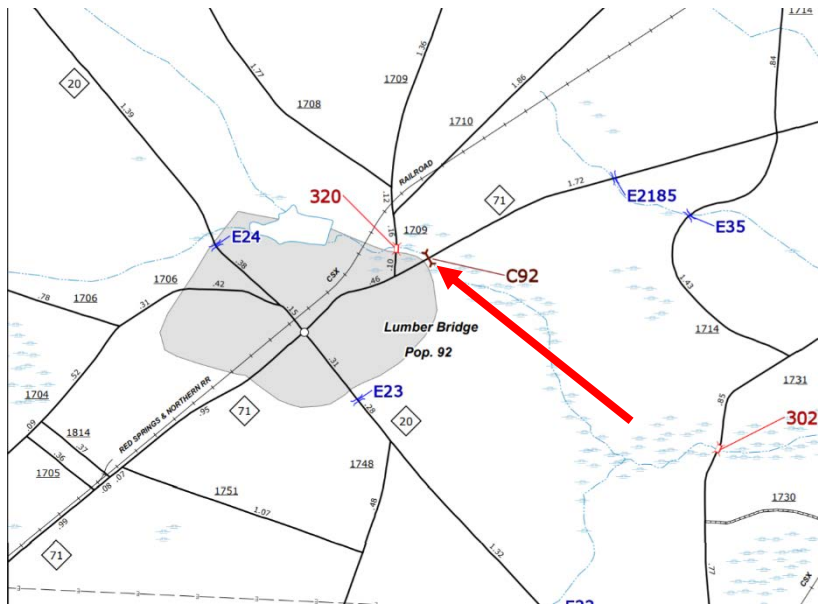
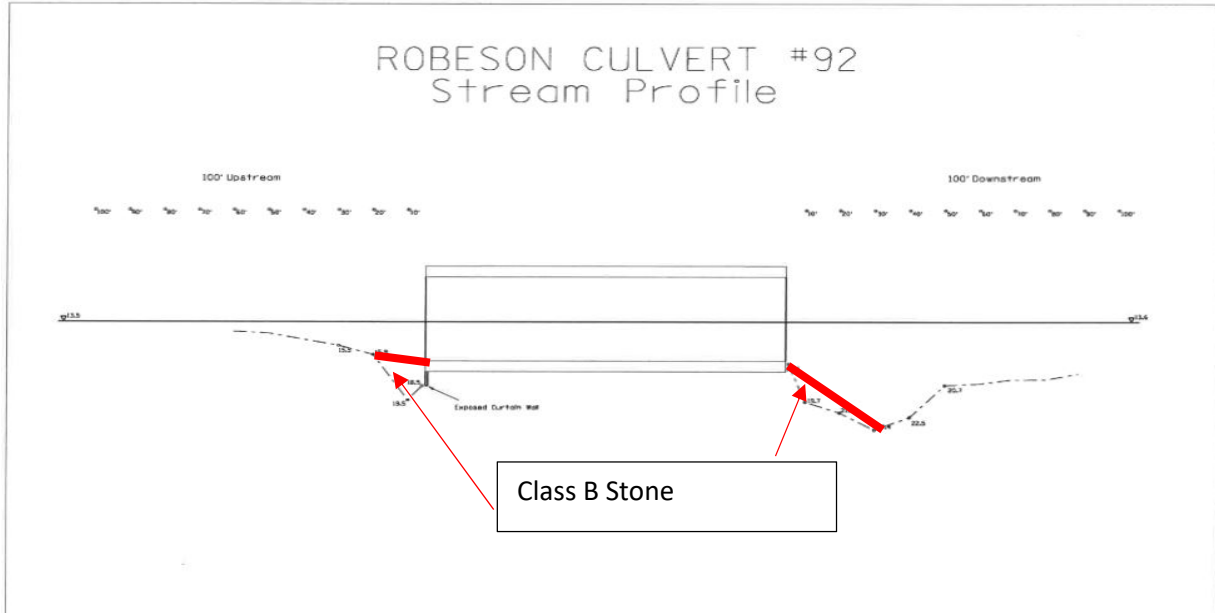

Contractor shall place Class B Stone in the scour hole located on the inlet and outlet side of the culvert. Contractor shall check the depth of stone prior, during, and after placement to ensure scour hole is filled.

Non-nylon matting shall be used at all sites on this project.

Hours of work restricted to daylight hours only. Lane closures will be permitted between the daylight hours of 7am-7pm, or as directed by the Engineer. Hours may be adjusted if periods of high traffic and back ups occur on the project.

WBS Number 15406.1078279

NC 710 1.05 mile N of SR 1318 34.785163 -79.194657

Culvert#770471 Scour Along Culvert Toewall of inlet and outlet of box culvert, approx.

44'W x 5'L X 3'H = 25 tons x 2= approx. 50 tons total, use non-nylon matting at all sites of this project

Hours of work restricted to daylight hours only. Lane closures will be permitted between the daylight hours of 7am-7pm, or as directed by the Engineer. Hours may be adjusted if periods of high traffic and back ups occur on the project.

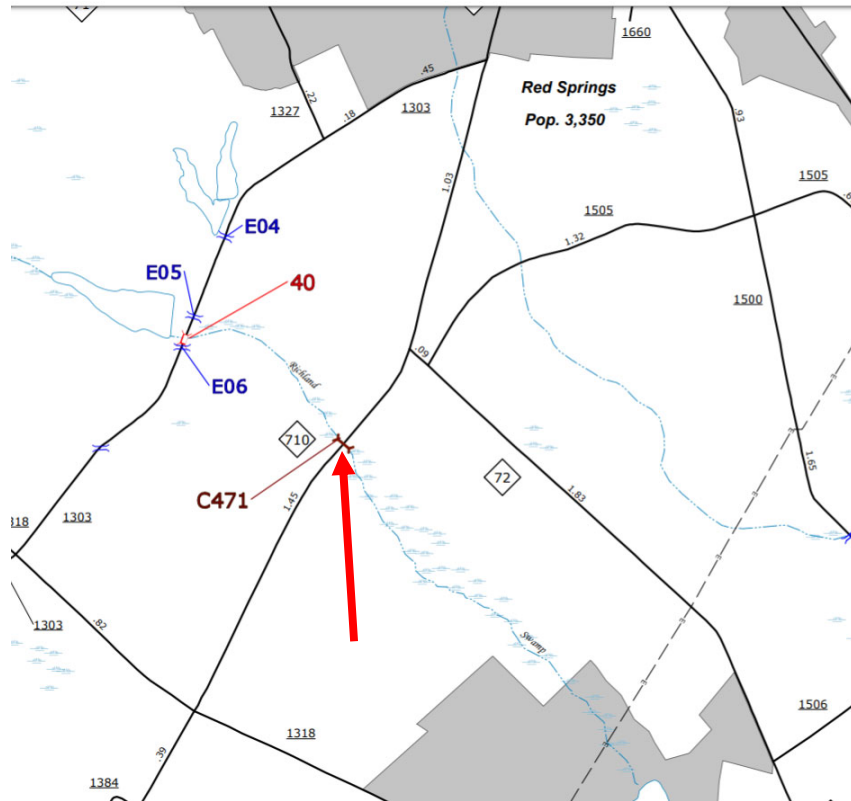
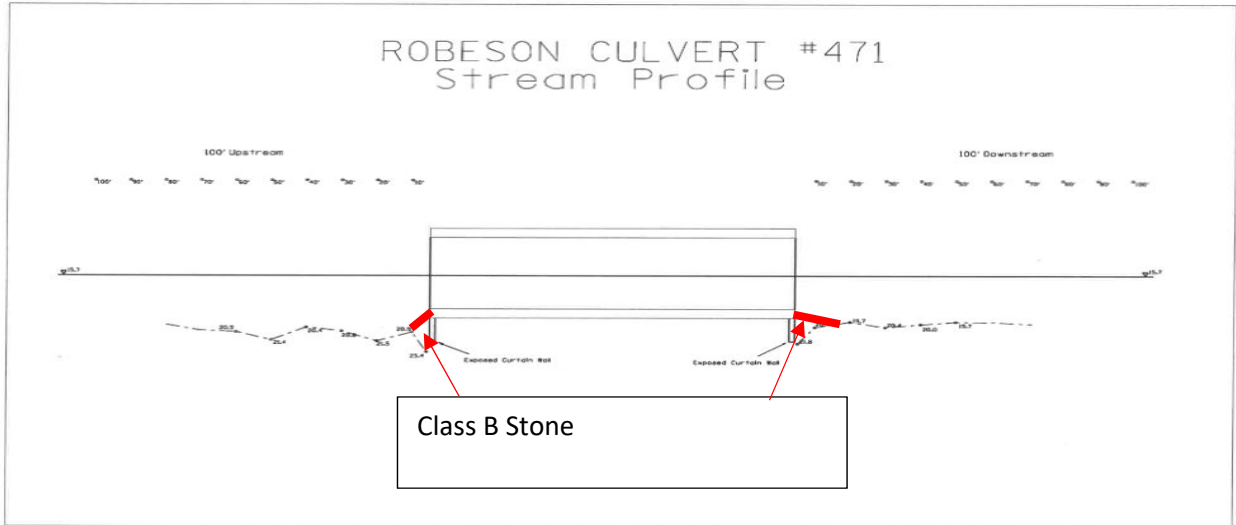

WBS Number 15406.1078280

I-95 (NBL) 0.48 mile S of SR 2455 34.548682 -79.207128
Culvert#770098 Scour Along Culvert Toewall 20'W X 5'L X 5'H = 25 tons x 2 approx 50 tons total

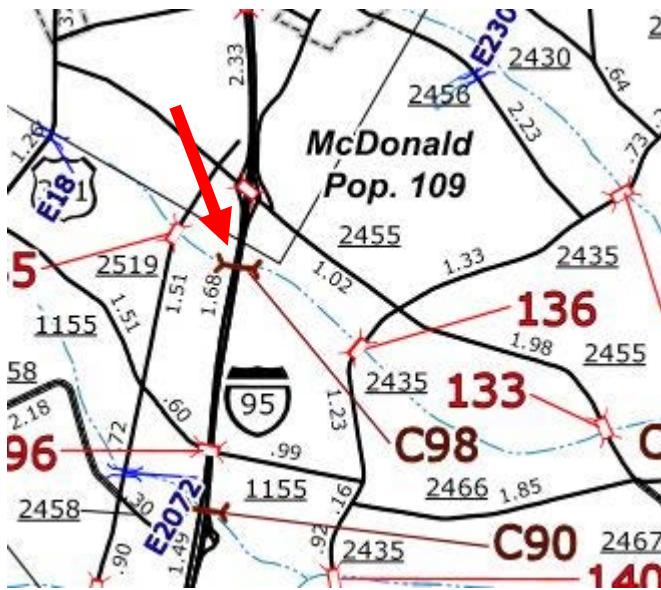
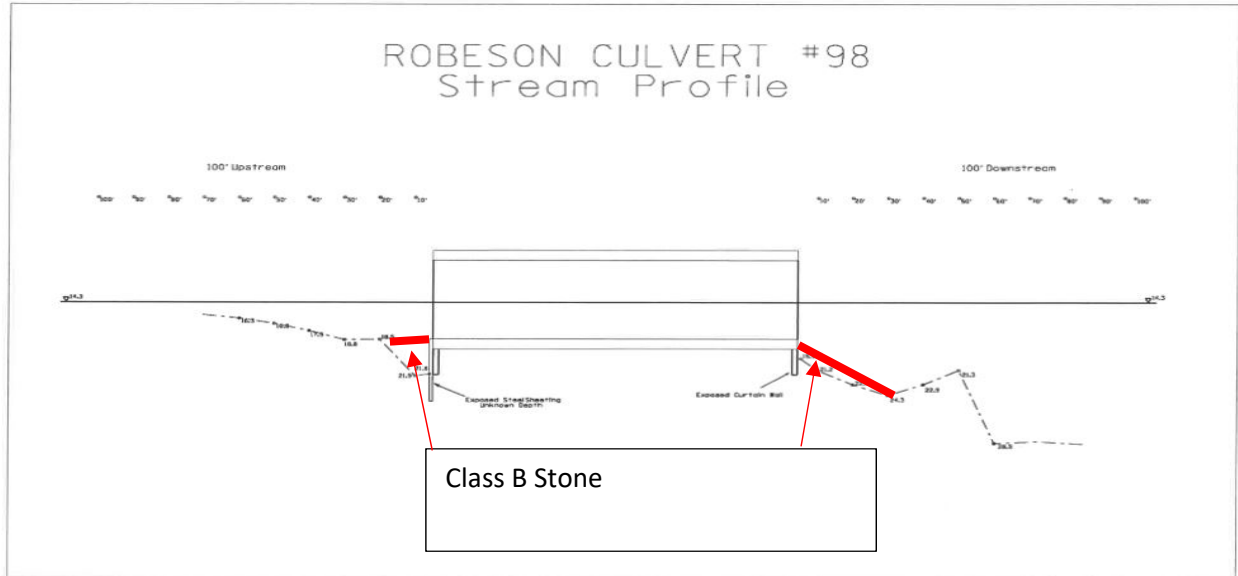

Contractor shall place Class B Stone in the scour hole located on the inlet and outlet side of the culvert. Contractor shall check the depth of stone prior, during, and after placement to ensure scour hole is filled. Turbidity curtain shall be used. Non-nylon matting shall be used at all sites on this project. Contractor shall place Class B Rip Rap as directed by the Engineer. Any required lane closures on 95 shall be completed at night. Lane closures on I-95 restricted to hours of work 9pm-6am Sun night and 7pm-6am Mon-Thurs night. No work on Saturdays or Holidays. Non-nylon matting shall be used at this slope and all others. Portable lighting is incidental to traffic control. Shoulder closures or work behind existing guardrail will be allowed during the daylight hours with a proper shoulder closures per Std. Dwgs.